

- Key**
- Carriageway resurfacing/construction
  - Footway resurfacing
  - Mandatory cycle lane
  - Red tactiles
  - New kerbs
  - SW drainage flow

- Notes**
1. Do not scale from this drawing.
  2. All dimensions are shown in metres unless shown otherwise.
  3. This drawing shows a proposed feasibility option and is subject to change.
  4. WBC standard details must be adhered to at all times unless specified by the overseeing organisation.

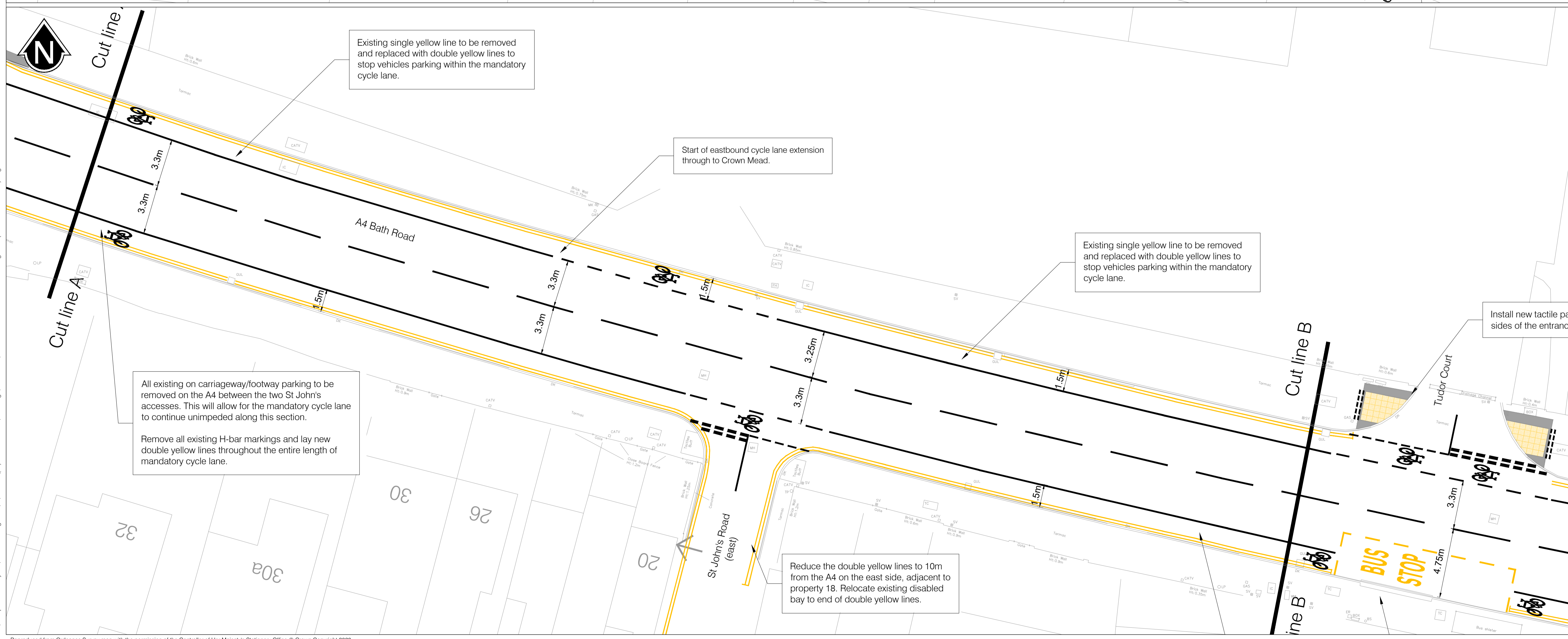

DRAFT

Rev	Rev date	Description	DR	AU



Environment  
Council Offices Market Street Newbury RG14 5LD

Project title  
**A4/Crown Mead  
Active Travel Improvements**

Drawing title  
**General Arrangement  
Plan 1 of 3**

Date	Drawn by	Checked by	Paper size	Scale
May 2024	DW	CT	A1	1:150

Drawing number	Revision
81236-A4CM-CL-100-1	C

Reproduced from Ordnance Survey map with the permission of the Controller of Her Majesty's Stationery Office © Crown Copyright 2023. Unauthorised reproduction infringes Crown Copyright and may lead to prosecution or civil proceedings. West Berkshire District Council 010024151.

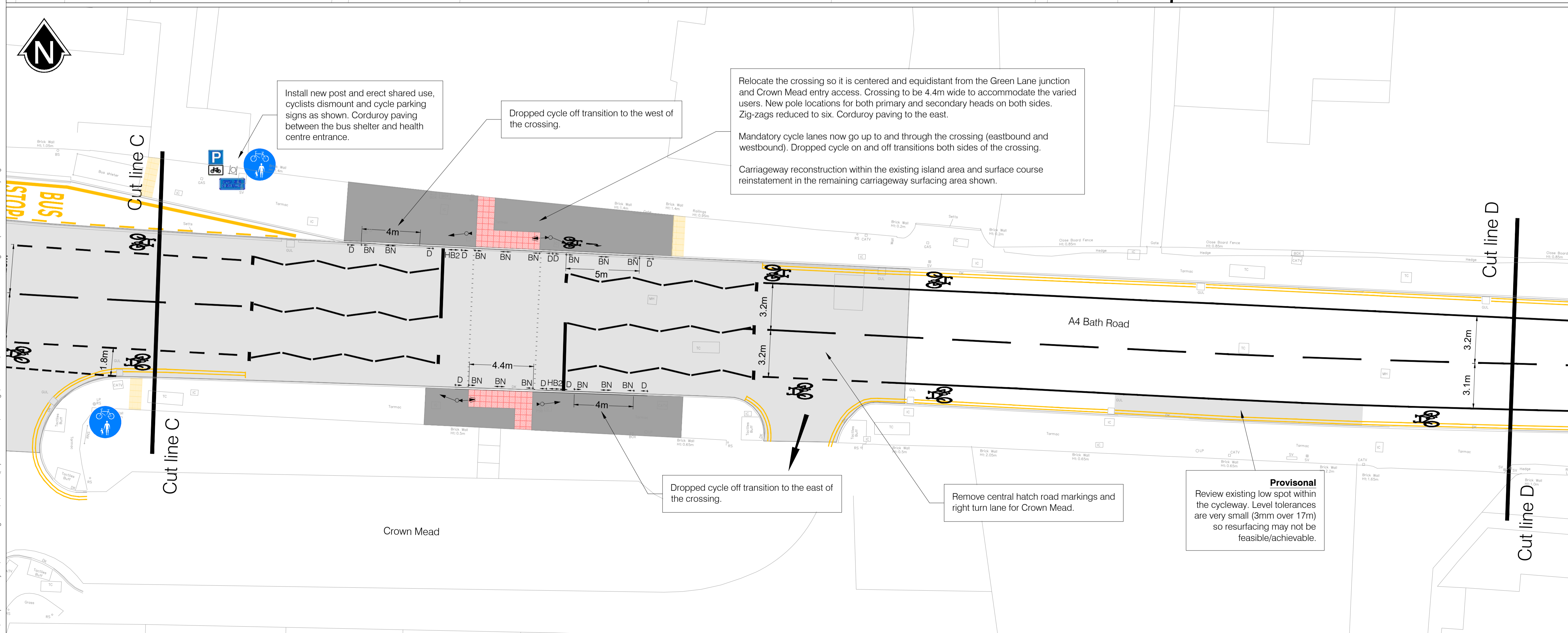
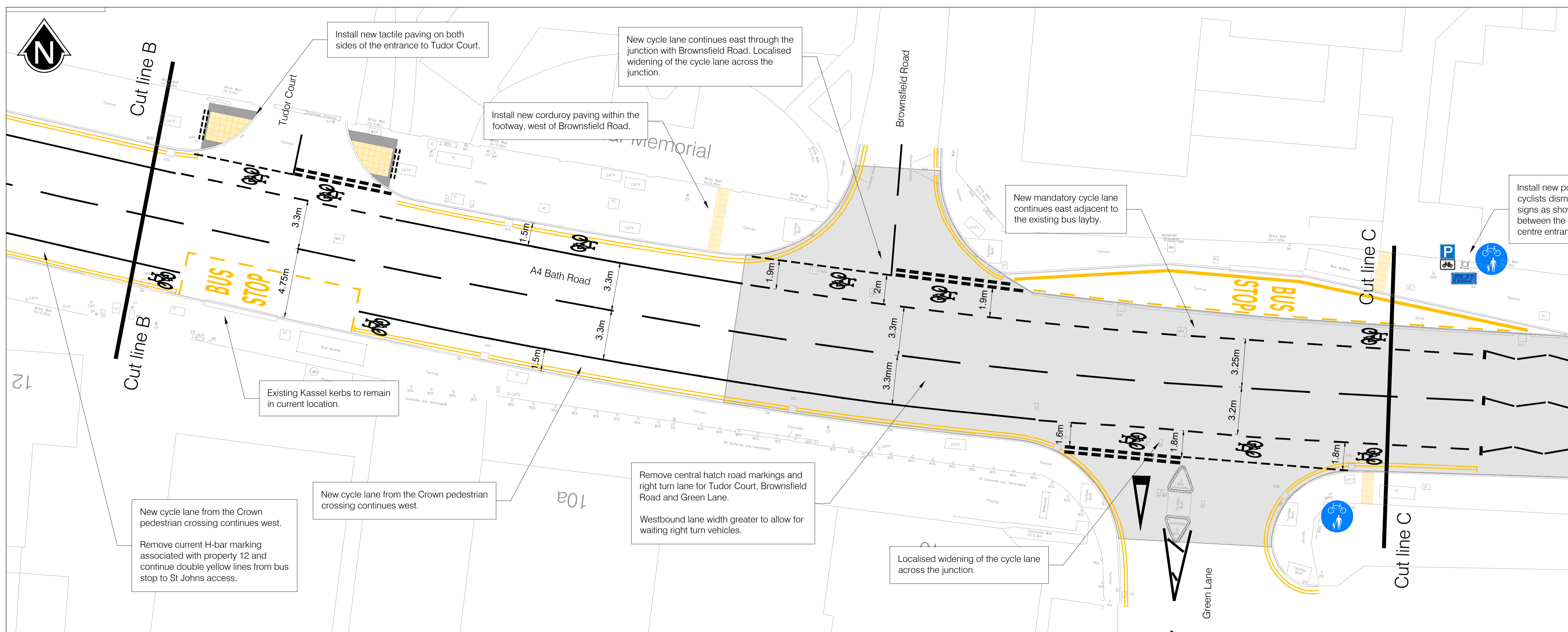

**Key**

- Carriageway resurfacing/construction
- Footway resurfacing
- Mandatory cycle lane
- Red tactiles
- New kerbs
- SW drainage flow

- Notes**
1. Do not scale from this drawing.
  2. All dimensions are shown in metres unless shown otherwise.
  3. This drawing shows a proposed feasibility option and is subject to change.
  4. WBC standard details must be adhered to at all times unless specified by the overseeing organisation.

DRAFT

Rev	Rev date	Description	DR	AU



Environment  
Council Offices Market Street Newbury RG14 5LD

Project title	A4/Crown Mead
Drawing title	Active Travel Improvements
Date	May 2024
Drawing number	81236-A4CM-CL-100-2
Drawn by	DW
Checked by	CT
Paper size	A1
Scale	1:150
Revision	C

Reproduced from Ordnance Survey map with the permission of the Controller of Her Majesty's Stationery Office © Crown Copyright 2023. Unauthorised reproduction infringes Crown Copyright and may lead to prosecution or civil proceedings. West Berkshire District Council 0100024151.

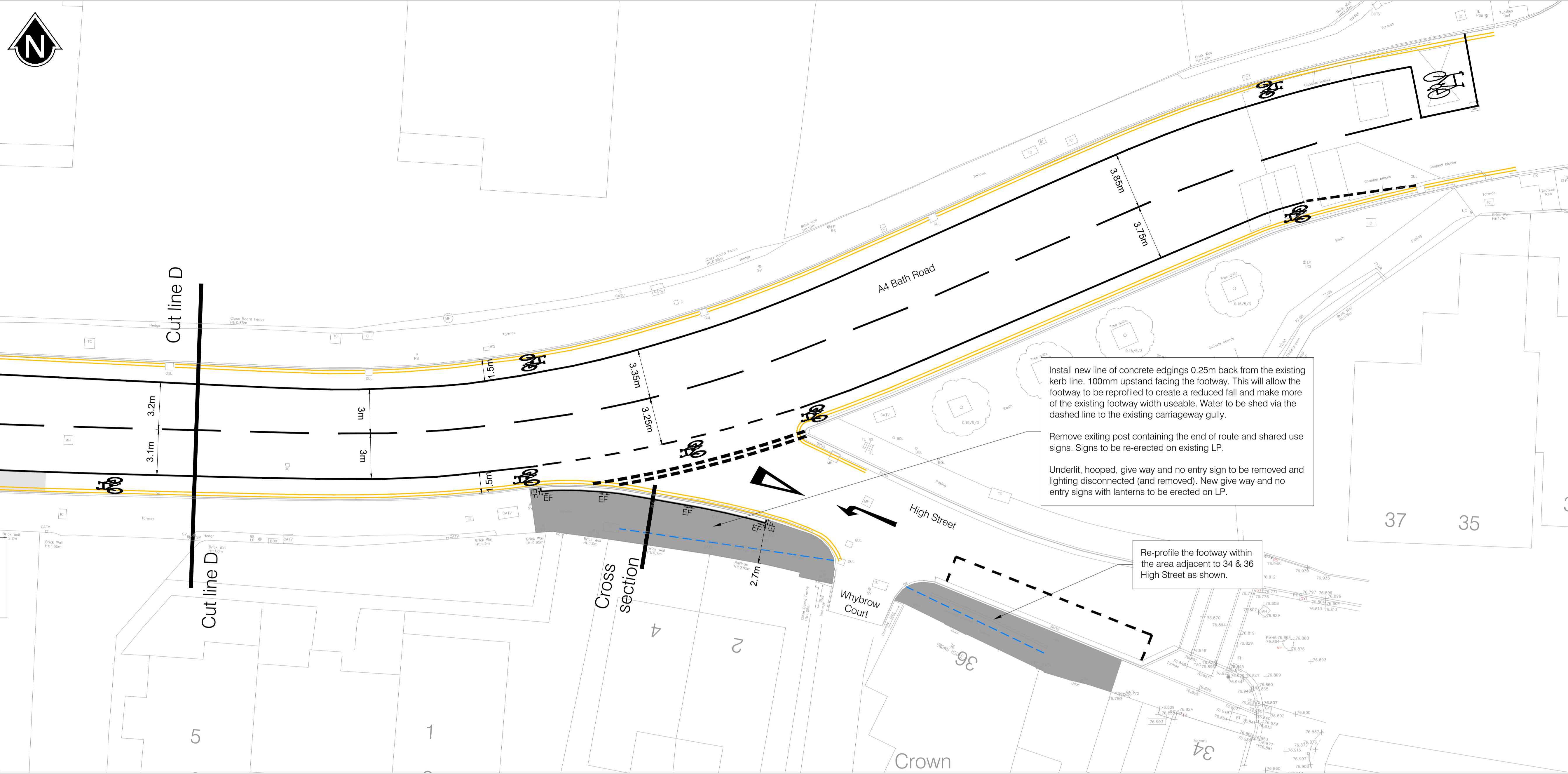

- Notes**
1. Do not scale from this drawing.
  2. All dimensions are shown in metres unless shown otherwise.
  3. This drawing shows a proposed feasibility option and is subject to change.
  4. WBC standard details must be adhered to at all times unless specified by the overseeing organisation.

**Footway cross-section west of Whybrow Court**  
Scale : n.t.s

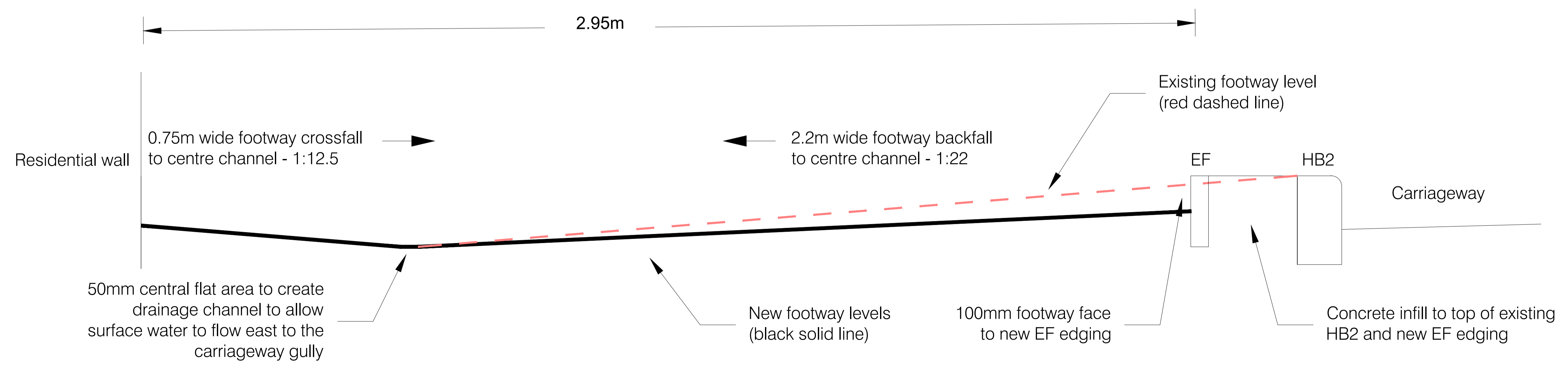

Rev	Rev date	Description	DR	AU



Environment  
Council Offices Market Street Newbury RG14 5LD

Project title				
A4/Crown Mead Active Travel Improvements				
Drawing title				
General Arrangement Plan 3 of 3				
Date				
May 2024	Drawn by DW	Check by CT	Paper size A1	Scale 1:150
Drawing number				
81236-A4CM-CL-100-3				Revision C

I:\Transport & Countryside\Network Management\HISchemes\A4 Crown Mead\Drawings\Consultation\81236-A4CM-CL-100-C - General Arrangement (Member Consultation).dwg