

From: [PlanningPolicy](#)
To: [PlanningPolicy](#)
Subject: FW: Affected response - Consultations on the submitted neighbourhood plans for Cold Ash and Hermitage (Regulation 16)
Date: 28 July 2023 12:30:22
Attachments: [Cold Ash EXOLUM PLAN.pdf](#)

From: Exolum Pipeline System Ltd <ExolumPipelinesystem@fishergerman.co.uk>
Sent: Friday, July 28, 2023 12:14 PM
To: PlanningPolicy <PlanningPolicy@westberks.gov.uk>
Subject: Affected response - Consultations on the submitted neighbourhood plans for Cold Ash and Hermitage (Regulation 16)

This is an EXTERNAL EMAIL. STOP. THINK before you CLICK links or OPEN attachments.

Dear Sirs

Thank you for your email to Exolum Pipeline System Ltd dated 21.07.2023 regarding the above. Please find attached a plan of our client's apparatus.

We would ask that you contact us if any works are in the vicinity of the Exolum pipeline or alternatively go to www.lsbud.co.uk, our free online enquiry service.

Kind regards,

Kayla

Kind Regards,

Exolum Pipeline System Ltd

This e-mail message is confidential and for the use of the addressee only. If the message is received by anyone other than the addressee it must be deleted. Internet e-mails are not secure and we do not accept responsibility for changes made to the message.

447900

448200

448500

448800

449100

449400

WARNING

THIS DRWG. IS NOT TO BE USED FOR CONSTRUCTION PURPOSES. THE LOCATION OF THE PIPE MUST BE VERIFIED AND PEGGED ON SITE BY THE PIPELINE OPERATOR BEFORE ANY EXCAVATION OR CONSTRUCTION WORK COMMENCES.

FOR FURTHER DETAILS PLEASE CONTACT FISHER GERMAN ON 0845 070 1245

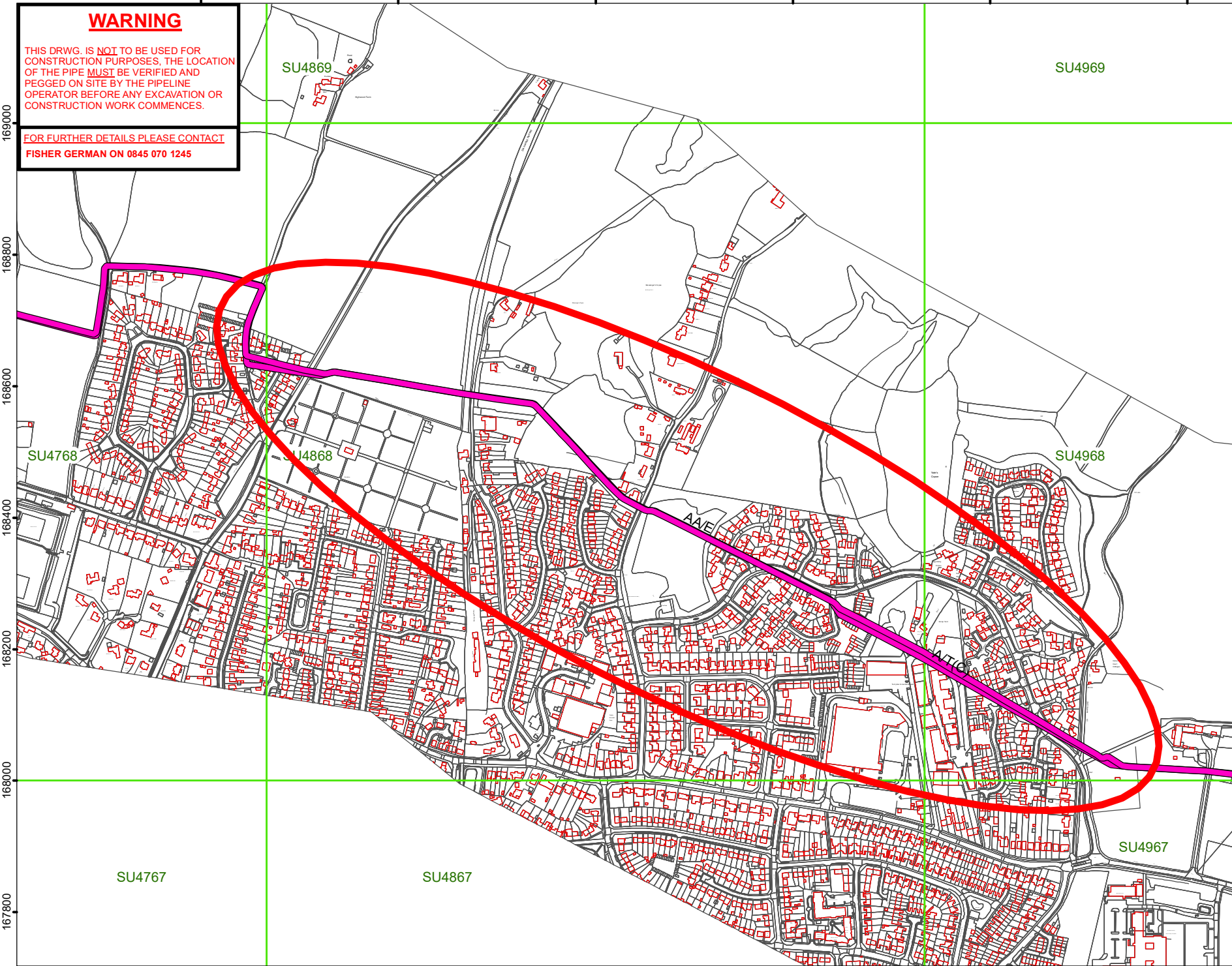

OVERVIEW WINDOW



Legend

EXOLUM

Cathodic Protection

Nearest Postcode:
RG18 9HE

Latitude & Longitude:
51.412626 , -1.3026245

Site centre coordinates:
448,547 - 168,450

Client:



TITLE:
LOCATION PLAN EXTRACT
OF PIPELINE A/A(E) & A/TC

SCALE: 1:7,500 @ A4
DATE: 26/07/2023

© Crown copyright and database rights 2023
Ordnance Survey Licence Number AC0000849937



THIS DRAWING IS PROTECTED BY COPYRIGHT.
IT MAY NOT BE REPRODUCED IN ANY FORM OR
BY ANY MEANS FOR ANY PURPOSE WITHOUT
WRITTEN PERMISSION OF FISHER GERMAN LLP
CHARTERED SURVEYORS
Information produced by HM Land Registry,
Crown copyright and database rights 2023.



The Estates Office,
Norman Court, Ashby de la Zouch,
Leicestershire, LE65 2UZ

Telephone 0845 070 1245

DRAWING NO:
Cold Ash

169000

168800

168600

168400

168200

168000

167800

SU4768

SU4869

SU4868

SU4969

SU4968

SU4967

SU4767

SU4867